



MAKES ANY SCREW CAPTIVE

ScrewClip – flexible, easy, safe



SCREWCLIP FOR M6 TO M10 SCREWS



A CLEVER LITTLE HELPING HAND FOR MOUNTING GUARDS

It's a problem as familiar to every fitter as it is routine: you release a screw, remove a part ... and when it comes to reattaching it, the screw has disappeared. This wastes time, creates stress and increases the risk of accidents. The OTTO ROTH Group offers a simple and effective solution to this issue: ScrewClip. This flexible captive retainer can be attached in a wide range of positions without having to modify its design, securing the screw without restricting function and making it captive. This not only makes the mounting process easier, it also fulfils the requirements of the European Machinery Directive 2006/42/EC.

ScrewClip makes any screw captive

Since 2009, fitters in the machine construction sector have had to comply with a new European directive on the attachment of guards such as grates, fences or covering parts. It stipulates that, once removed (during maintenance work, for example), all fasteners must stay connected to the machine or guard. The reason for this is simple: screws that are not secured to the corresponding part are easily lost during disassembly. This wastes time, causes stress during reassembly and can lead to expensive delays. What's more, it increases the danger of incorrect or incomplete assembly and, as such, the risk of accident. Insurance companies often reject claims in situations like this.

We offer a simple, yet effective aid to solve exactly this problem: ScrewClip. This flexible captive retainer made from heat-resistant elastomer secures screws to the corresponding guard quickly and easily. The ScrewClip can be effortlessly retrofitted and secured via just one hole, does not restrict the function of the screw and ensures that said screw stays connected to the machine or guard even after it has been released. It is therefore not possible to lose or mix up the fasteners. Plus, ScrewClip has been subjected to DEKRA type testing to prove that it makes screws captive.

The advantages of our new screw retainer at a glance

- › Simple mounting, even in locations that are hard to access
- › No special variant is needed for particular screws
- › ScrewClip is reusable
- › Overhead work is made easier
- › Not possible to mix up screws
- › High resistance to heat (-40 °C to +90 °C)
- › Type-tested (DEKRA) according to the Machinery Directive 2006/42/EC Annex I, 1.4.2.1

Further information

› www.screwclip.de

Suitable for all types of screw

The original ScrewClip is made from heat-resistant SBR elastomer. It can be attached in a wide range of positions and is suitable for all types of screw. The captive retainer is available in thread sizes **M6, M8 and M10**.

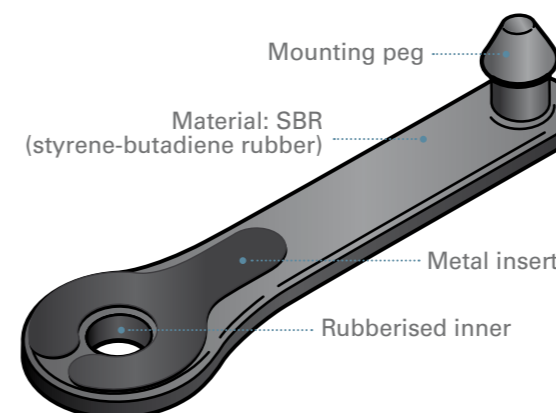

Greater flexibility with the ScrewClip Vario

We offer the ScrewClip Vario for use with particularly thick or thin walls or special materials. An additional hole in place of the mounting peg means this product can be securely connected to the guard using a screw or clip, giving greater flexibility during mounting.



Lots of customers are benefiting from ScrewClip

The ScrewClip can be used on fixed guards found on machines and plants in many different industries. Lots of customers from various sectors are already enjoying great success with this innovation.

The ScrewClip is available from our online shops

› www.ottoroth.de/shop
› www.berlinerschrauben.de/shop

EXAMPLE APPLICATIONS



The flexible captive retainer can be attached in various mounting positions without having to modify its design – including in an L-shaped or a bent position.



Retrofitted on the fixed guard of an automotive manufacturer's machinery using a standard M8 screw.



Attached to the protective housing on a bag shredder.



The ScrewClip is also ideal for mounting on curved surfaces, such as hoods

SCREWCLIP

DATA AND MOUNTING



| | ScrewClip 6 | ScrewClip 8 | ScrewClip 8 Vario | ScrewClip 10 |
|---|--------------------------------|-------------|---------------------|--------------|
| Mounting hole | Ø 6 ± 0.1 | Ø 6 ± 0.1 | Depends on fastener | Ø 8 ± 0.1 |
| Distance between holes for mounting | 50 mm | 50 mm | 50 mm | 75 mm |
| Max. permissible material thickness of mounting peg | 5 mm | 5 mm | 5 mm | 10 mm |
| Max. permissible torque | 22 Nm | 45 Nm | 45 Nm | 75 Nm |
| Metal insert material | 1.4301 stainless steel | | | |
| Elastomer type | SBR (styrene-butadiene rubber) | | | |
| Temperature range | -40 °C to +90 °C | | | |
| Colour | RAL 9005 (Jet Black) | | | |
| Suitable for use with foods | No | | | |

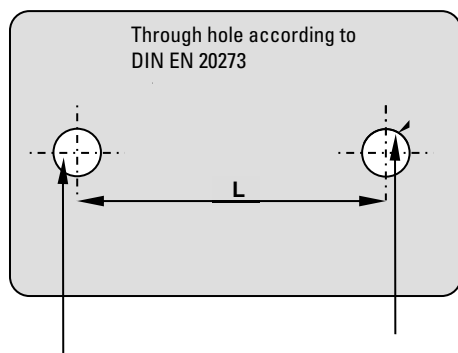

Mounting hole

Ø 6 ± 0.1 for size 6 and 8
Ø 8 ± 0.1 for size 10
Distance between holes L

Notes

- ▶ We recommend that you calculate the diameter of the mounting hole on a case by case basis. The optimum diameter may vary, depending on the nature of the guard (sheet thickness, paint finish, etc.).
- ▶ It is best to mount the ScrewClip by hand. Simply align the mounting peg so it is straight and press firmly with your thumb to attach the ScrewClip.
- ▶ We recommend using the ScrewClip with a washer.
- ▶ You can combine the ScrewClip with any screw you like.

Data sheets to download

▶ www.screwclip.de/datasheets



Press the mounting peg into the retaining hole.

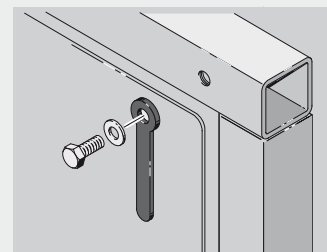

Push screw (with washer) through the holes in the ScrewClip and in the guard.

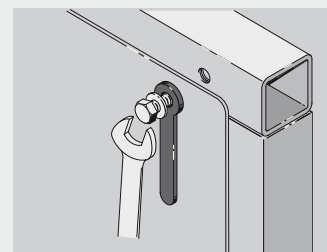

Screw tight. Done!

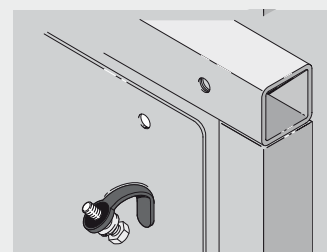

When the screw is released, it is still connected to the guard.



Our locations

▶ Otto Roth GmbH & Co KG

Stuttgart
Buchen/Odenwald
Augsburg
Nuremberg
Chemnitz

▶ Berliner Schrauben GmbH & Co KG

Berlin
Münster
Oer-Erkenschwick

▶ Heinz Bergmann GmbH & Co. KG

Hamburg

Headquarters of the OTTO ROTH Group

OTTO ROTH GmbH & Co KG
Rutesheimer Strasse 22
70499 Stuttgart, Germany
Tel. +49 (0) 711 1388-0
Fax +49 (0) 711 1388-233

Email: info@ottoroth.de
Website: www.ottoroth.de